



**Design, Manufacturing & Distribution —  
Motion Control Equipment**  
10761 Ahern Avenue S. E. Watertown, MN. 55388  
Phone: 952-955-2626 e-Fax: 480-247-4096  
www.midwestmotion.com  
email: randy@midwestmotion.com

## MMP-PSPS-65W-12V DC Power Supply

## PRODUCT DESCRIPTION



- Low cost, high reliability
- 105°C output capacitor
- International AC input range
- Built in EMI filter, low ripple noise
- High efficiency, low working temperature
- Soft-start circuit, limiting AC surge current
- Short circuit, overload protection
- Compact size, light weight
- 100% full load burn-in test
- UL1950, TUV EN60950-1 approved
- CISPR22 (EN55022)

The PSPS65 open frame series offers universal input, and offers designers a low cost approach.

| SPECIFICATIONS <i>(All specifications apply at 25°C unless otherwise noted.)</i> | VALUE                     |
|--|---------------------------|
| <b>INPUT</b>   |                           |
| Input Voltage Range  | 120 VAC                   |
| <b>OUTPUT</b>  |                           |
| Output Current   | 5 Amps, at 12V DC Nominal |
| Voltage Accuracy   | ±3% max.                  |
| Line Regulation (HL-LL)  | ±0.5% max.                |
| Load Regulation (20-100% load)   | ±3% max.                  |
| Short Circuit Protection   | N/A                       |
| Ripple/Noise (20MHz BW)  | 100mV p-p                 |
| <b>GENERAL</b>   |                           |
| Efficiency   | 79% typ.                  |
| Isolation Voltage (input to output)  | 3KV (1 min)               |
| <b>ENVIRONMENTAL</b>   |                           |
| Operating Temperature (ambient)  | -10°C to +60°C            |
| Storage Temperature  | -20°C to +85°C            |
| Humidity (non-condensing)  | 10% to 95% RH             |
| <b>PHYSICAL</b>  |                           |
| Dimensions   | 5.0" x 3.0" x 1.65"       |
| Weight   | 18 Oz.                    |
| Case Material  | open frame                |
| Shielding  |                           |

Due to advances in technology, specifications are subject to change without notice.

## NOTES

- 1) All parameters are specified at 115VAC input, rated load at 25°C ambient.
- 2) Tolerance includes set up tolerance, line regulation and load regulation.
- 3) Ripple & noise are measured at 20MHz bandwidth using a 12" twisted pair terminated with 0.1uf & 47uf parallel capacitor.
- 4) Outputs provide up to maximum current, but limited to maximum output power.
- 5) Mounting holes should be grounded for EMI purposes.
- 6) All case and pin-to-case measurements for reference only unless otherwise noted.

### Mechanical Specification

Unit:mm

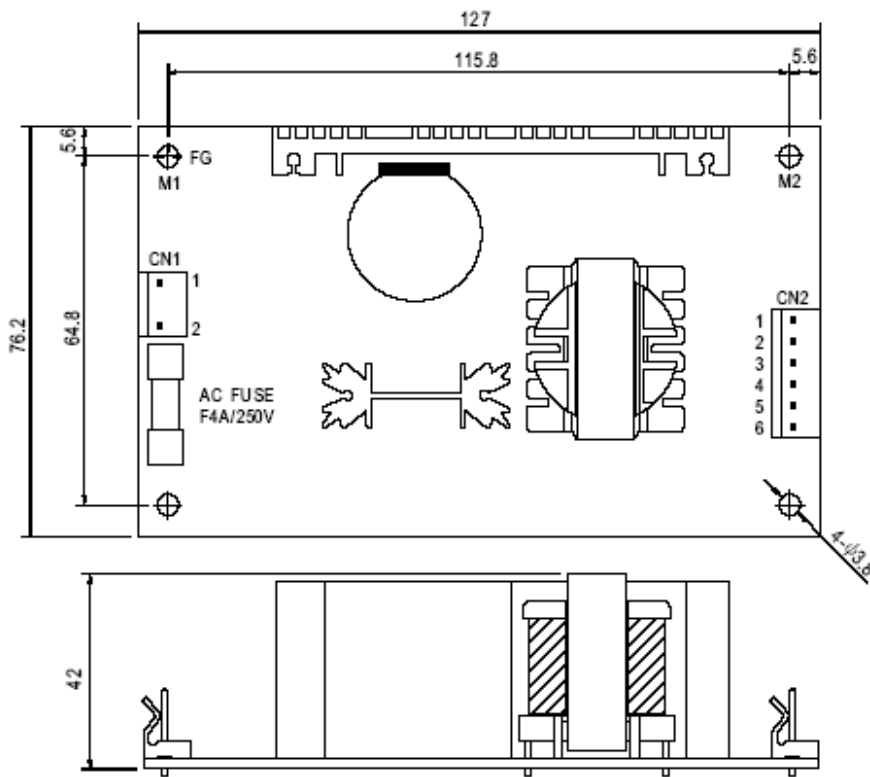

AC Input Connector (CN1) : Molex 5277-02 or equivalent

| Pin No. | Assignment | Mating Housing              | Terminal                    |
|---------|------------|-----------------------------|-----------------------------|
| 1       | AC/N       | Molex 5195<br>or equivalent | Molex 5194<br>or equivalent |
| 2       | AC/L       |                             |                             |

DC Output Connector (CN2) : Molex 5273-06 or equivalent

| Pin No. | Assignment | Mating Housing              | Terminal                    |
|---------|------------|-----------------------------|-----------------------------|
| 1,2,3   | +V         | Molex 5195<br>or equivalent | Molex 5194<br>or equivalent |
| 4,5,6   | -V         |                             |                             |



**MIDWEST MOTION PRODUCTS**  
10761 Ahern Avenue S. E. Watertown, MN. 55388  
Phone: 952-955-2626 e-Fax: 480-247-4096  
www.midwestmotion.com email: randy@midwestmotion.com